

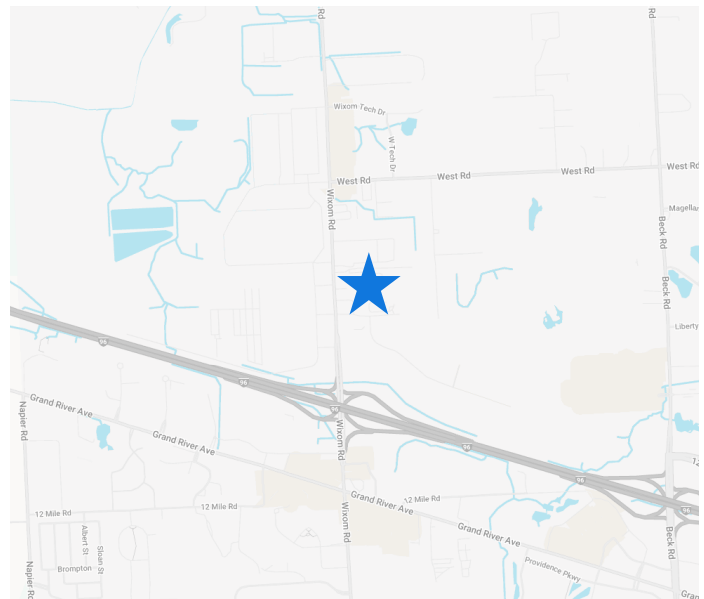

WIXOM-ALPHA SHOPPES
28870 Wixom Road, Wixom, MI 48393

PROPERTY DETAILS

- Turnkey Restaurant Available Consisting of Approximately 2,091 Sq. Ft.
- Located on the East Side of Wixom Road, Just North of I-96
- Directly Across from Menard's, At Home and Aldi at Signalized Intersection
- Strong Trade Area Which Includes Meijer, Target, Sam's Club, Home Depot, Kroger, Staples as well as Multiple National Restaurant Chains and Hotels
- Excellent Opportunity to Join Sherwin Williams and AT&T
- Traffic Counts at Wixom and Alpha Drive are 30,979 VPD



SITE PLAN

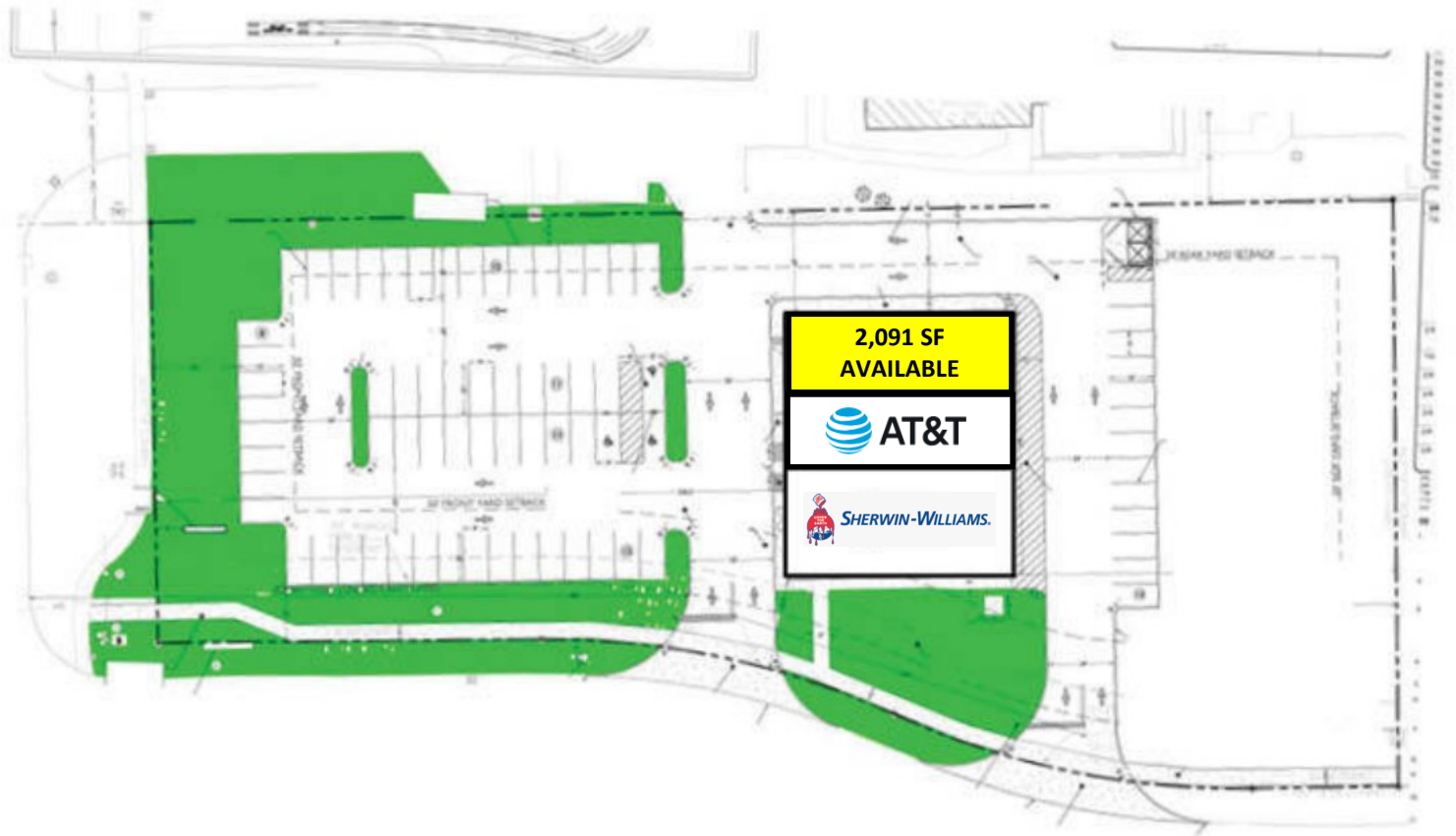

FLOOR PLAN

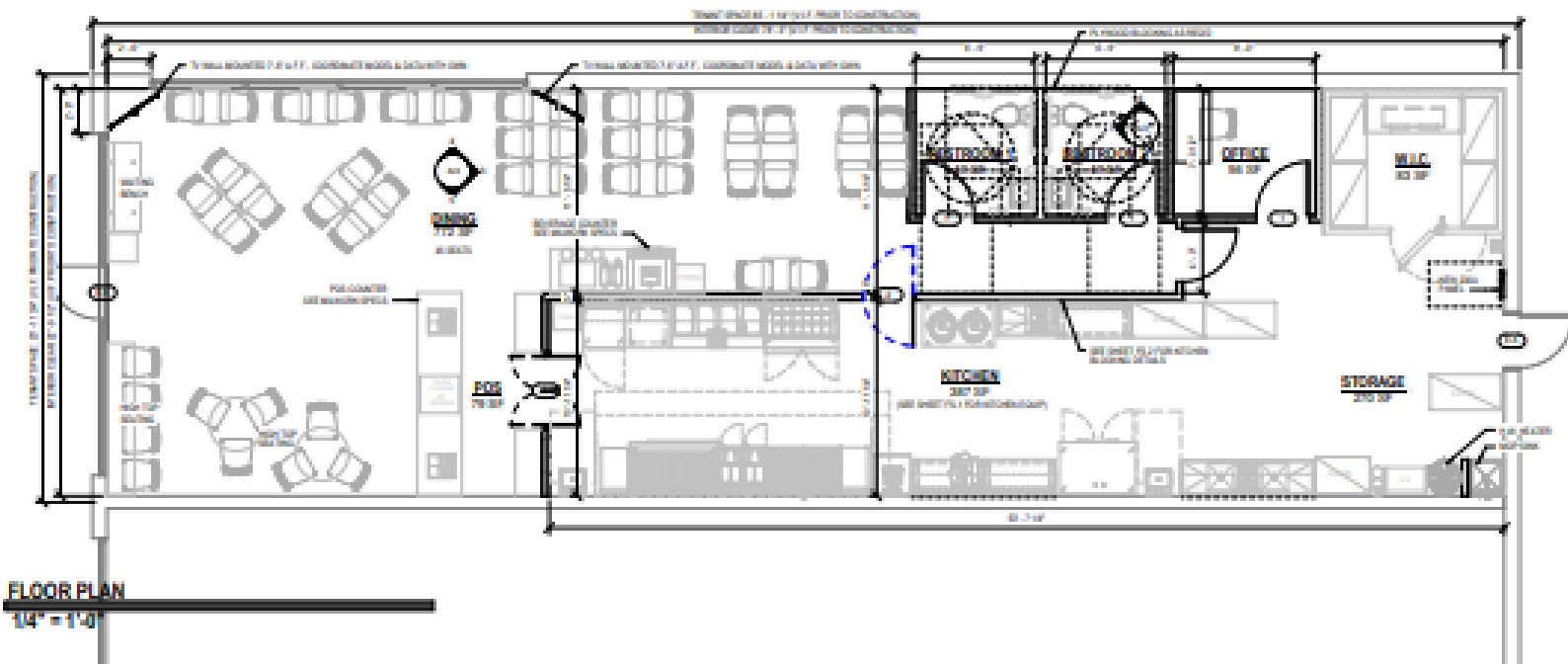

EXTERIOR PHOTOS



INTERIOR PHOTOS



RETAIL AERIAL

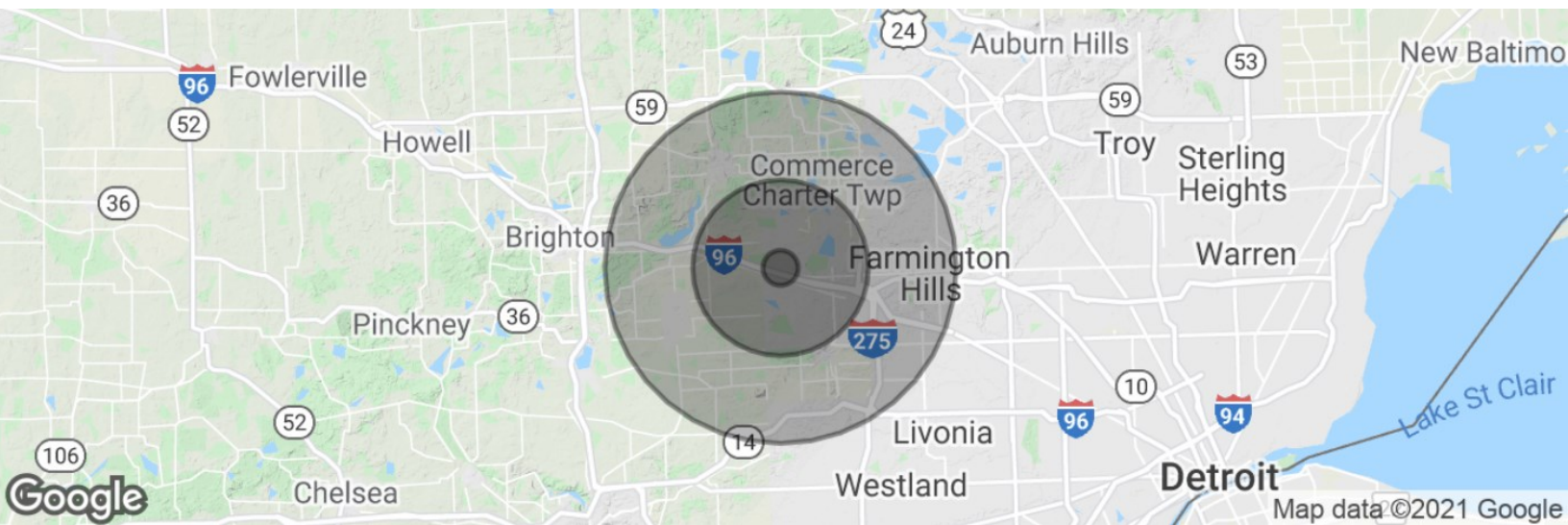

DEMOGRAPHIC DATA

POPULATION	1 MILE	3 MILES	5 MILES
Total Population	1,153	39,027	109,701
Median Age	39.7	38.0	41.0
Median Age (Male)	30.8	36.5	38.9
Median Age (Female)	28.7	37.4	41.0

HOUSEHOLD INCOME	1 MILE	3 MILES	5 MILES
Total Households	1,579	35,655	146,511
Persons Per Household	1.8	2.5	2.6
Average Household Income	\$83,359	\$116,516	\$124,797
Median Home Value	\$346,478	\$392,683	\$363,623